

ROADWAY WIDTH
REDUCED FROM
32.5' TO 26.5'
(TYP @ AREAS
w/PARKING)

PROPOSED REMOVAL
OF EXISTING PARKING
AREA (TYP)

PROPOSED 8.5' WIDE
RAISED MEDIAN ISLAND
(TYP)

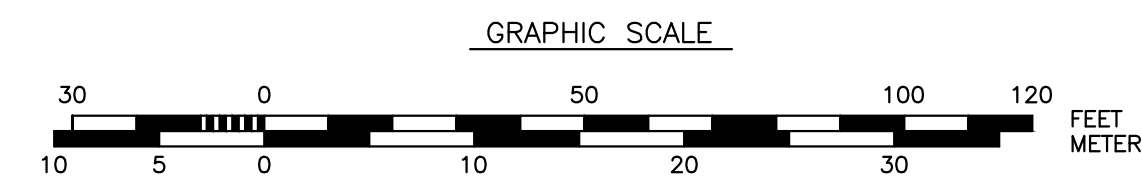
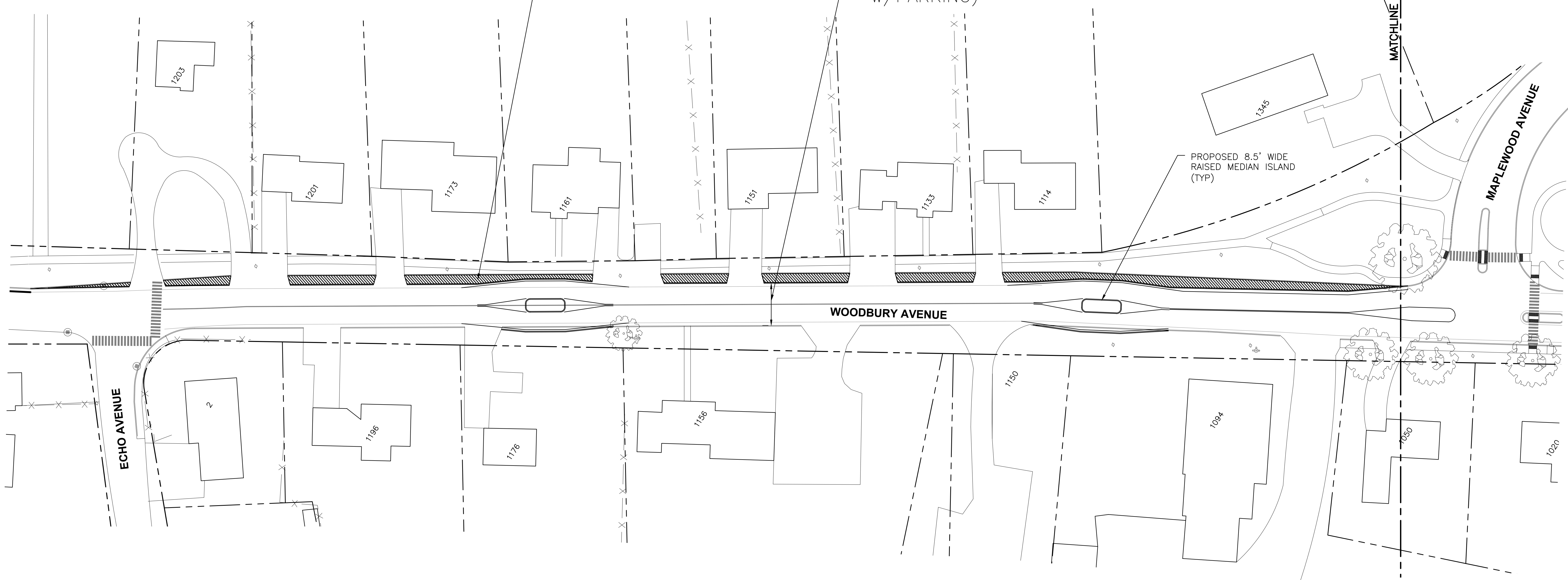

B	PUBLIC MEETING & FEBRUARY P.T.S.	MRB	1/26/23
A	INTERNAL REVIEW	MRB	1/20/23
NO.	REVISIONS	APP'D	DATE
PROJECT: WOODBURY AVENUE TRAFFIC CALMING			
TITLE: ROADWAY LAYOUT PLAN			
DRAWING SCALE: AS SHOWN		DATE: JANUARY 2023	
PROJECT NO.: 7247		SHEET: C-101	
APPROVED BY: MRB			

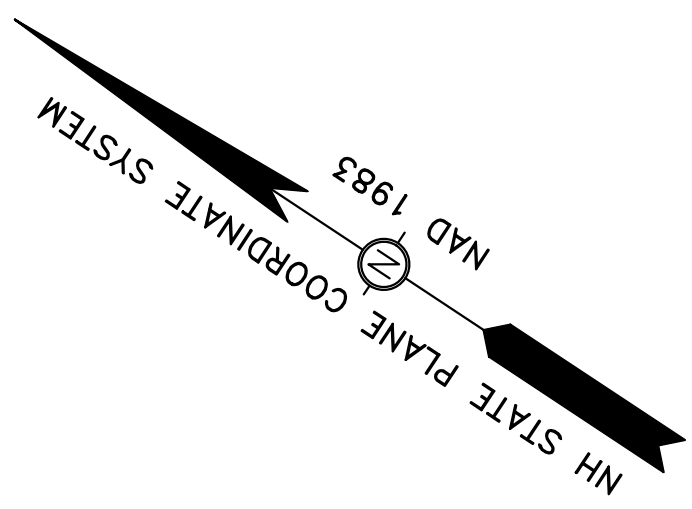

ROADWAY WIDTH
REDUCED FROM
32.5' TO 26.5'
(TYP @ AREAS
w/PARKING)

PROPOSED REMOVAL
OF EXISTING PARKING
AREA (TYP)

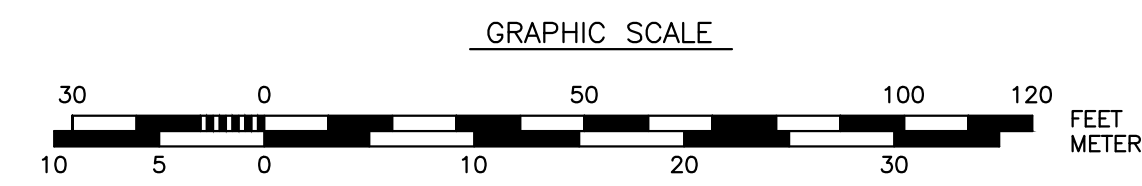
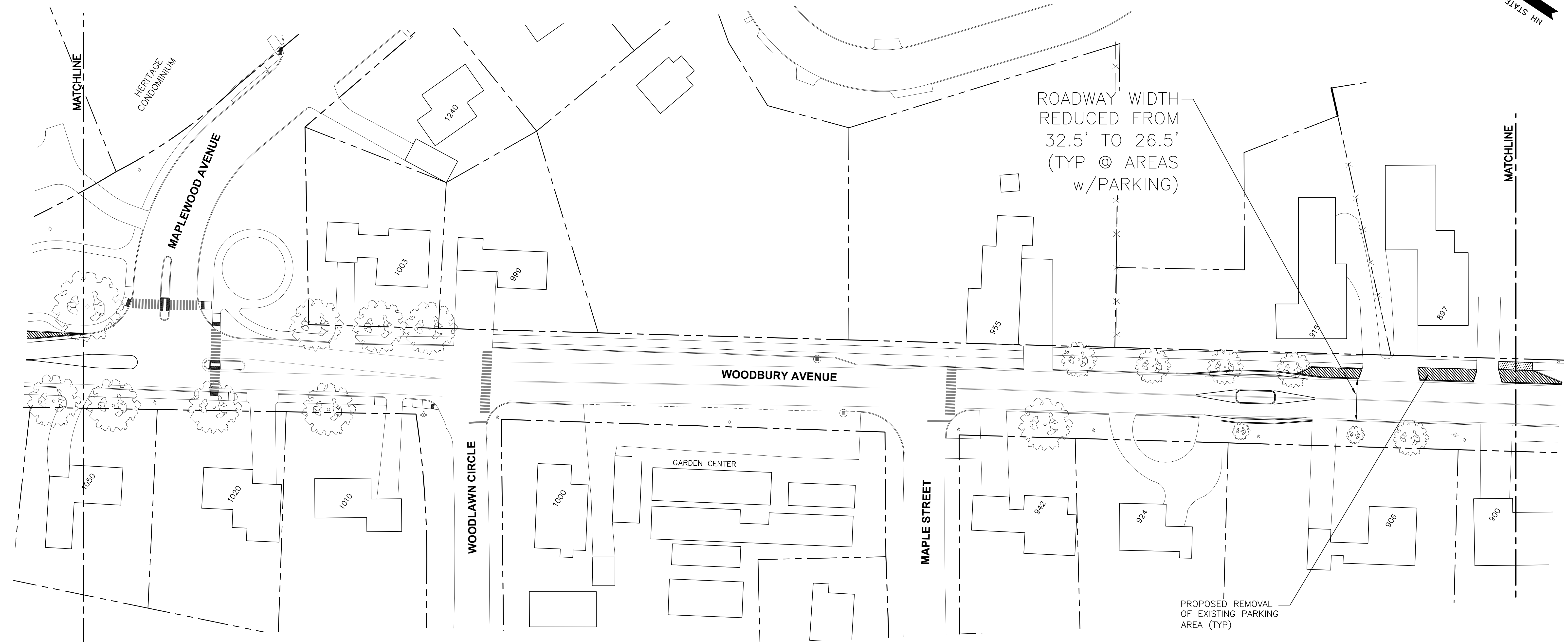

B	PUBLIC MEETING & FEBRUARY P.T.S.	MRB	1/26/23
A	INTERNAL REVIEW	MRB	1/20/23
NO.	REVISIONS	APP'D	DATE
PROJECT:		WOODBURY AVENUE TRAFFIC CALMING	
TITLE:		ROADWAY LAYOUT PLAN	
DRAWING SCALE:		AS SHOWN	DATE: JANUARY 2023
PROJECT NO.:		7247	SHEET: C-102
APPROVED BY:		MRB	

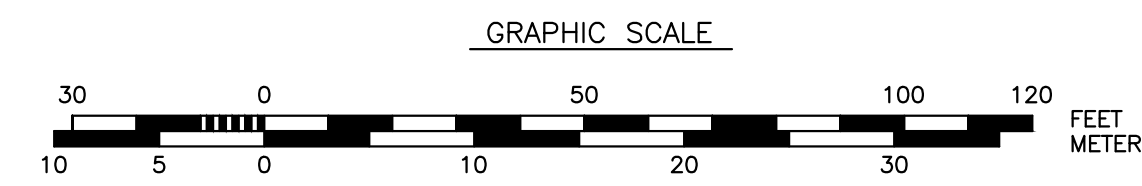
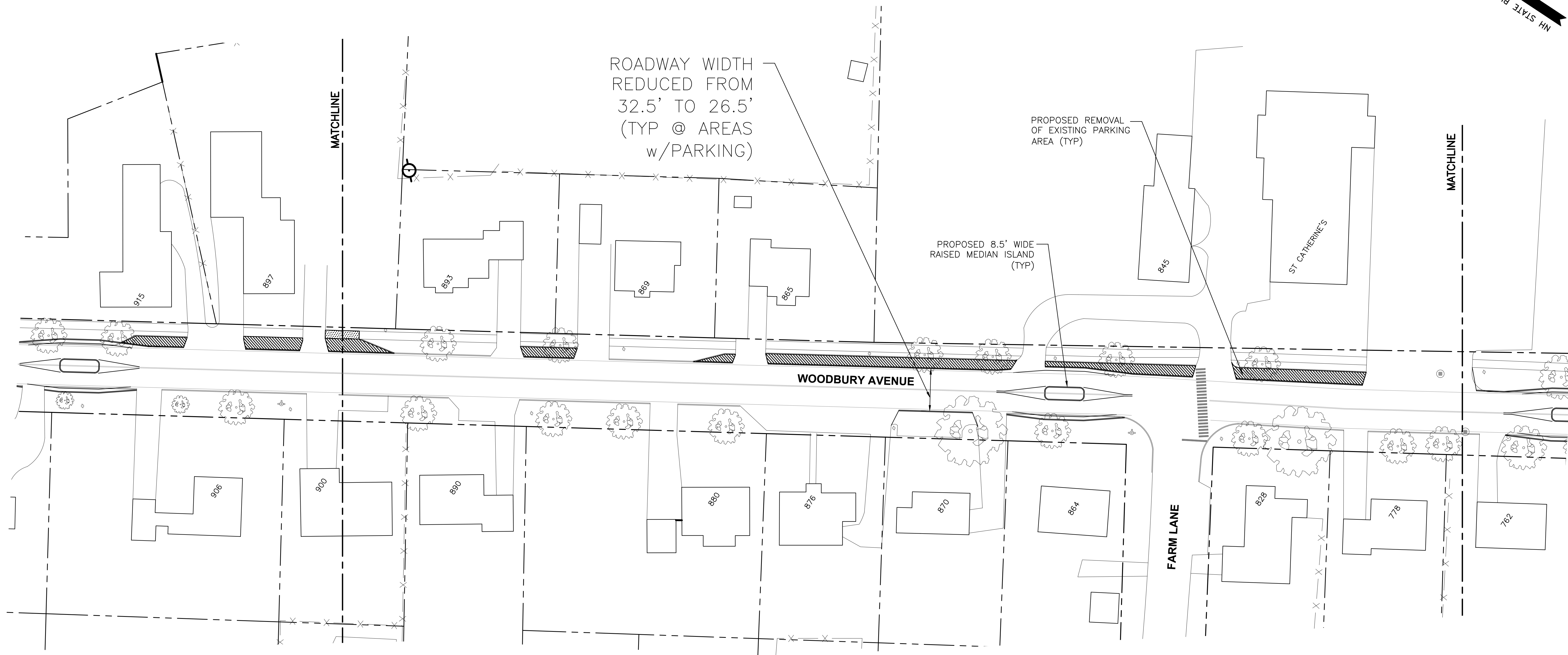
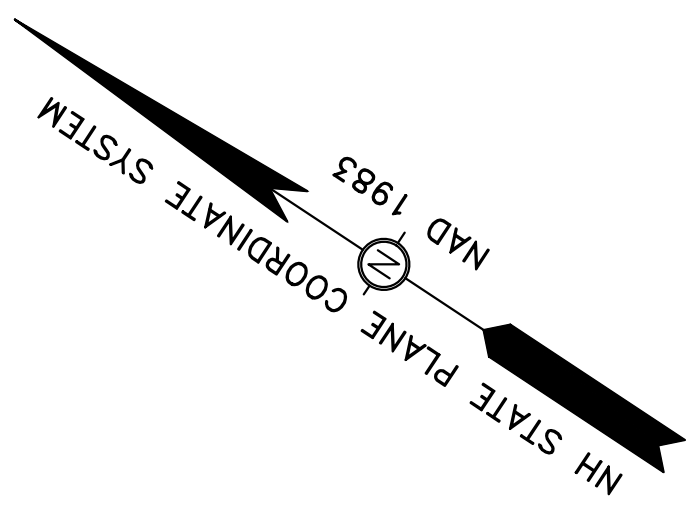

B	PUBLIC MEETING & FEBRUARY P.T.S.	MRB	1/26/23
A	INTERNAL REVIEW	MRB	1/20/23
NO.	REVISIONS	APP'D	DATE
PROJECT: WOODBURY AVENUE TRAFFIC CALMING			
TITLE: ROADWAY LAYOUT PLAN			
DRAWING SCALE: AS SHOWN		DATE: JANUARY 2023	
PROJECT NO.: 7247		SHEET: C-103	
APPROVED BY: MRB			

NH STATE PLANE COORDINATE SYSTEM
 NAD 1983

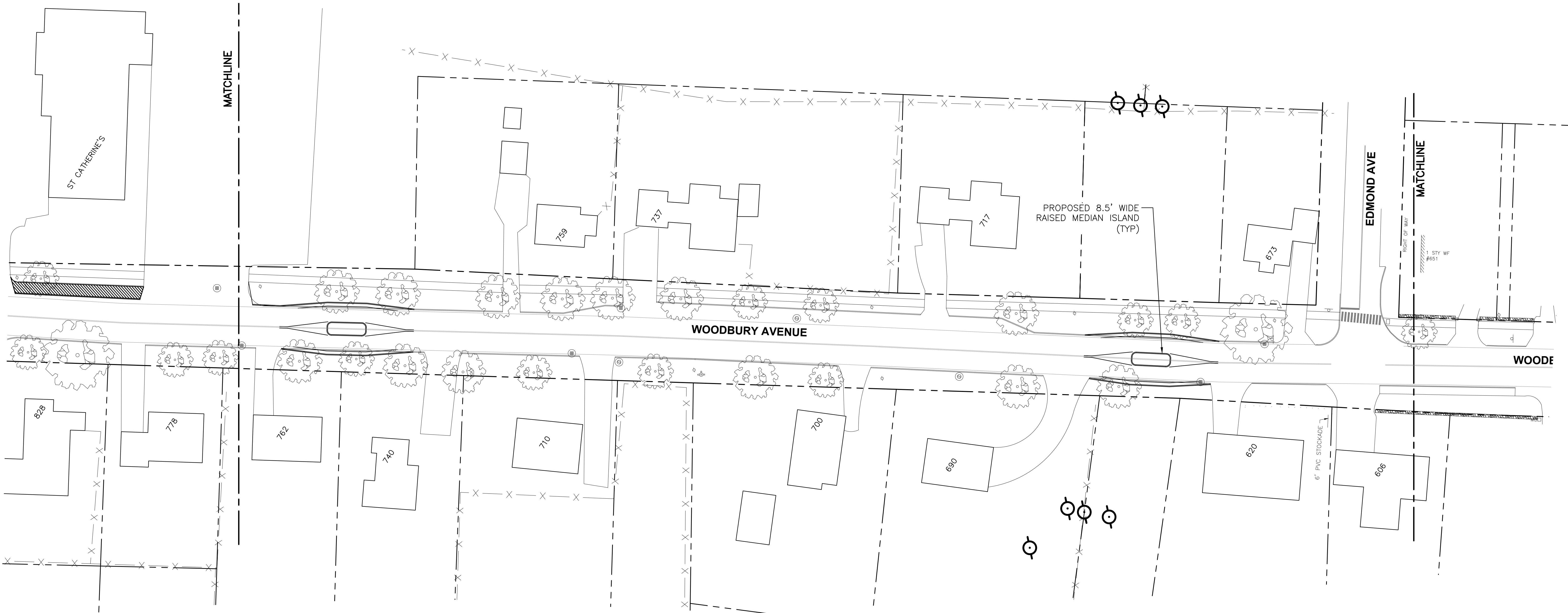

WOODBURY AVENUE

WOODE

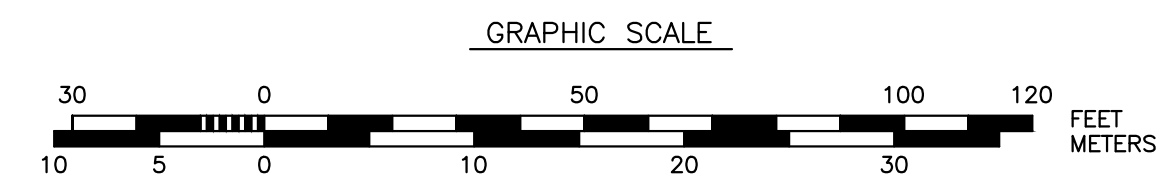

PROJECT:			
WOODBURY AVENUE TRAFFIC CALMING			
TITLE:			
ROADWAY LAYOUT PLAN			
DRAWING SCALE:	AS SHOWN	DATE:	JANUARY 2023
PROJECT NO.:	7247	SHEET:	C-104
APPROVED BY:	MRB		
NO.		REVISIONS	APP'D DATE
B	PUBLIC MEETING & FEBRUARY P.T.S.		MRB 1/26/23
A	INTERNAL REVIEW		MRB 1/20/23

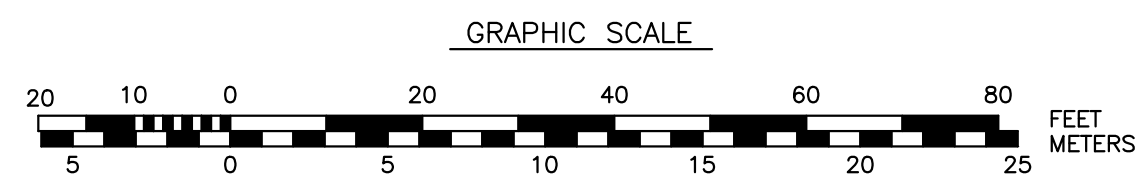
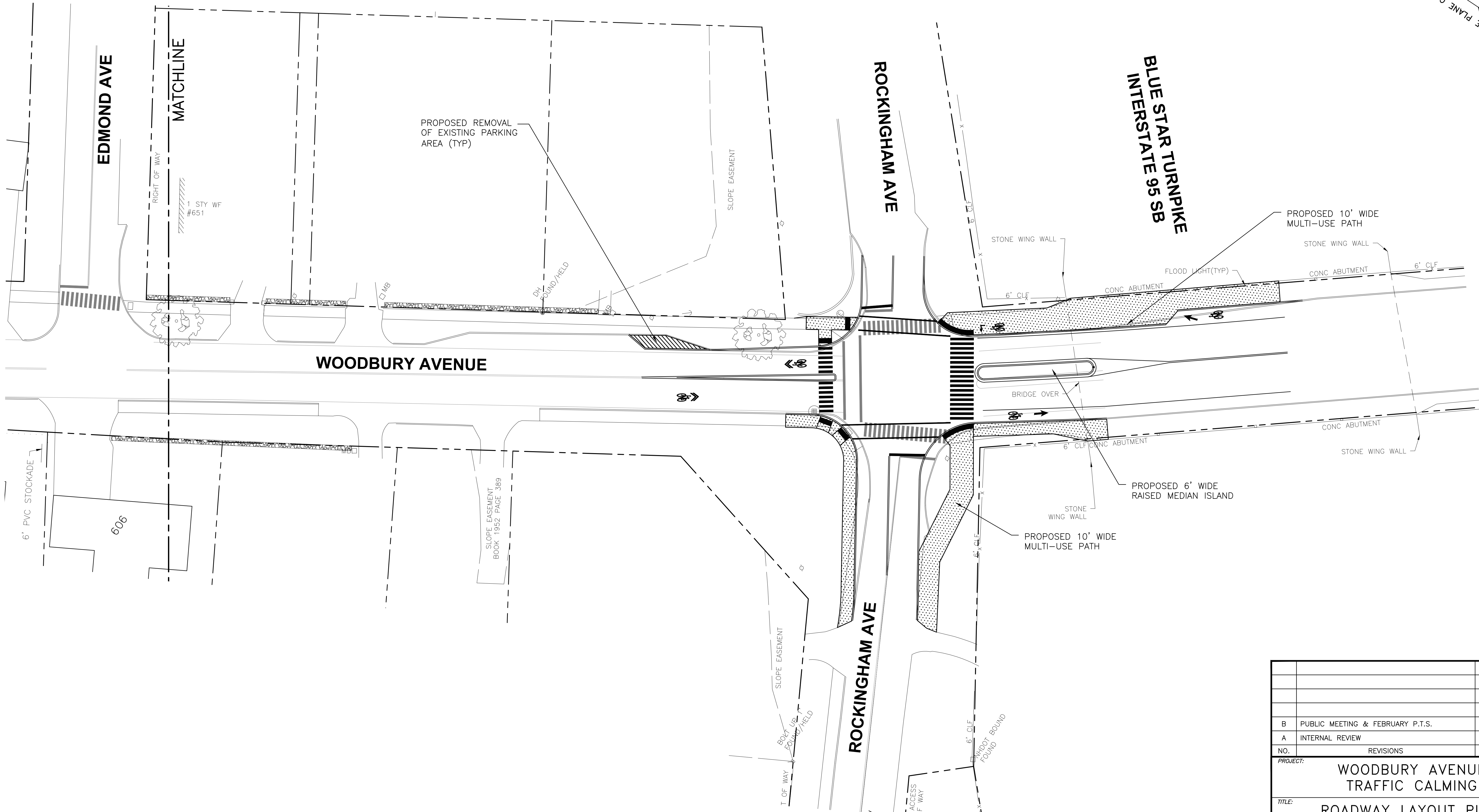
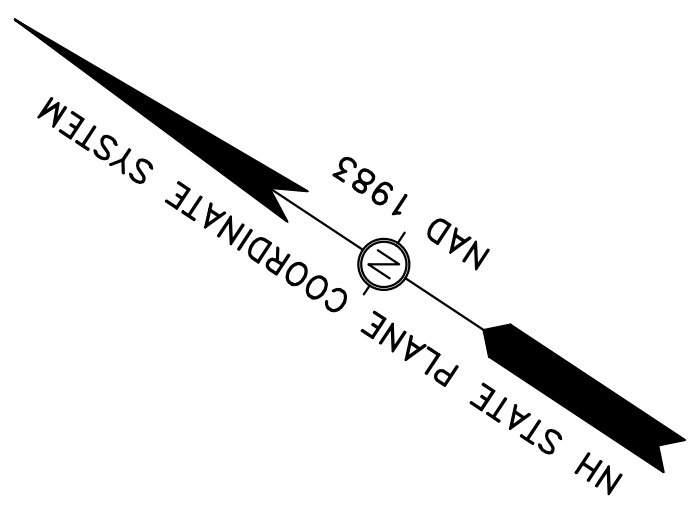

B	PUBLIC MEETING & FEBRUARY P.T.S.	MRB	1/26/23
A	INTERNAL REVIEW	MRB	1/20/23
NO.	REVISIONS	APP'D	DATE
PROJECT: WOODBURY AVENUE TRAFFIC CALMING			
TITLE: ROADWAY LAYOUT PLAN			
DRAWING SCALE:	AS SHOWN	DATE:	JANUARY 2023
PROJECT NO.:	7247	SHEET:	C-105
APPROVED BY:	MRB		

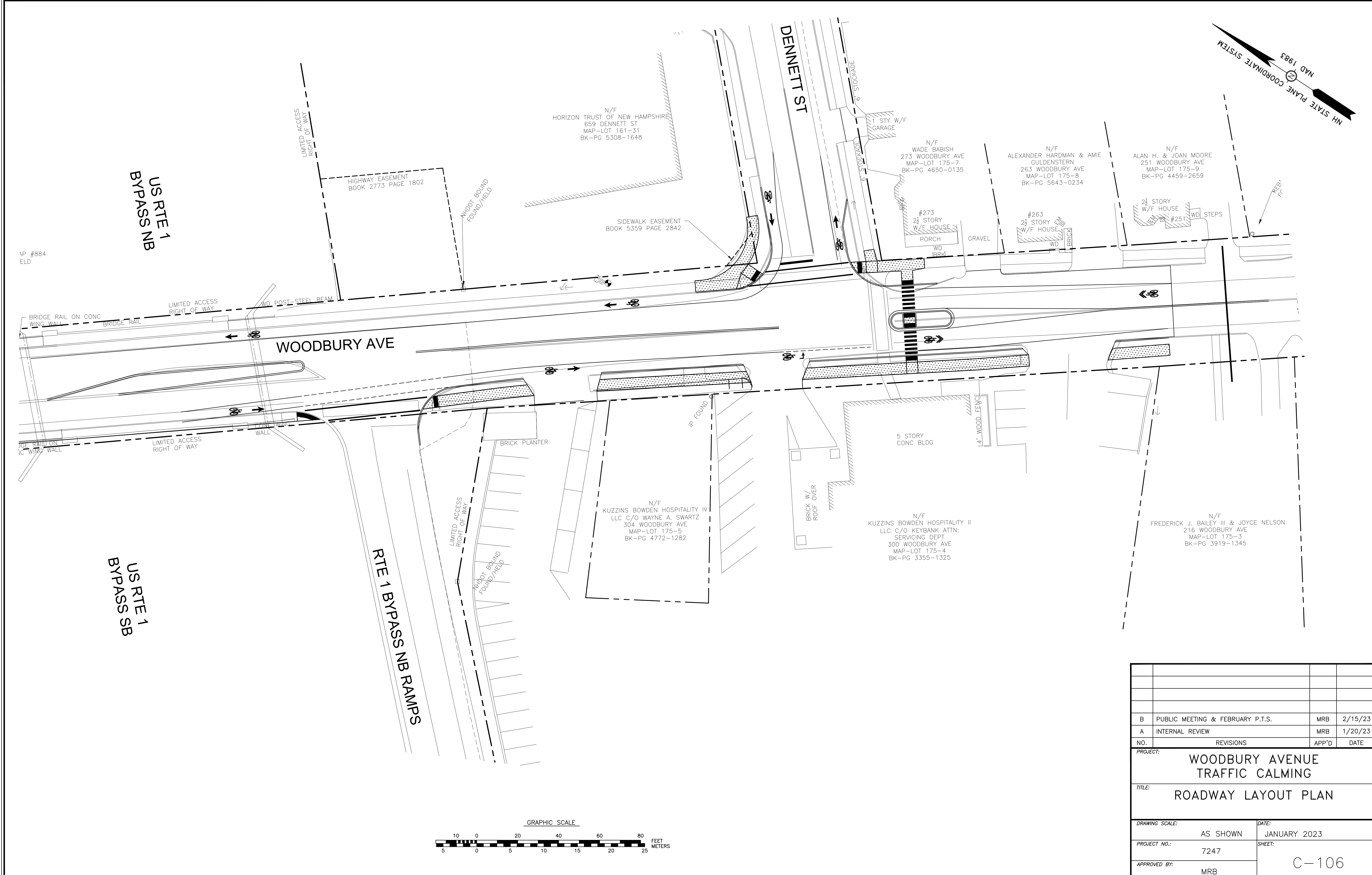
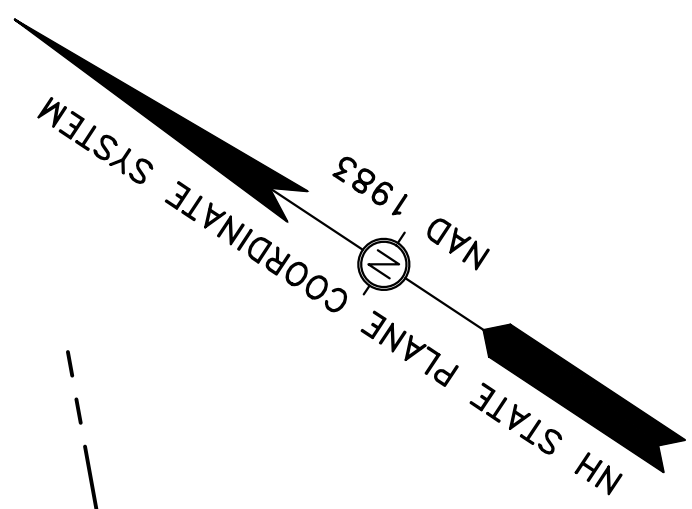

AP #884
ELD

US RTE 1
BYPASS NB

US RTE 1
BYPASS SB

RTE 1 BYPASS NB RAMPS

WOODBURY AVE

DENNETT ST

N/F
HORIZON TRUST OF NEW HAMPSHIRE
659 DENNETT ST
MAP-LOT 161-31
BK-PG 5308-1648

SIDEWALK EASEMENT
BOOK 5359 PAGE 2842

STY W/F
GARAGE

N/F
WADE BABISH
273 WOODBURY AVE
MAP-LOT 175-7
BK-PG 4650-0135

N/F
ALEXANDER HARDMAN & AMIE
GULDENSTERN
263 WOODBURY AVE
MAP-LOT 175-8
BK-PG 5643-0234

N/F
ALAN H. & JOAN MOORE
251 WOODBURY AVE
MAP-LOT 175-9
BK-PG 4459-2659

#273
2 1/2 STORY
W/F HOUSE
PORCH

#263
2 1/2 STORY
W/F HOUSE

2 1/2 STORY
W/F HOUSE

5 STORY
CONC BLDG

N/F
KUZZINS BOWDEN HOSPITALITY IV
LLC C/O WAYNE A. SWARTZ
304 WOODBURY AVE
MAP-LOT 175-5
BK-PG 4772-1282

N/F
KUZZINS BOWDEN HOSPITALITY II
LLC C/O KEYBANK ATTN:
SERVICING DEPT
300 WOODBURY AVE
MAP-LOT 175-4
BK-PG 3355-1325

N/F
FREDERICK J. BAILEY III & JOYCE NELSON
216 WOODBURY AVE
MAP-LOT 175-3
BK-PG 3919-1345

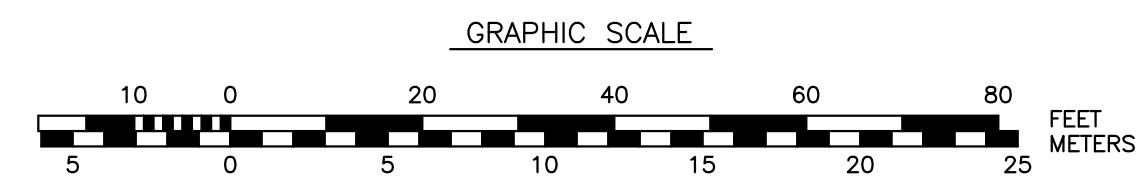

B	PUBLIC MEETING & FEBRUARY P.T.S.	MRB	2/15/23
A	INTERNAL REVIEW	MRB	1/20/23
NO.	REVISIONS	APP'D	DATE
PROJECT: WOODBURY AVENUE TRAFFIC CALMING			
TITLE: ROADWAY LAYOUT PLAN			
DRAWING SCALE: AS SHOWN		DATE: JANUARY 2023	
PROJECT NO.: 7247		SHEET: C-106	
APPROVED BY: MRB			